

Nazgul DC5 ECO V1.1

机架组装示意图

Frame Assembly Guide

1. 顶板 Top plate	x1	26. M3*6 内六角螺丝 M3*6 hex screw	x5
2. 中板 Counter plate	x1	27. M3*8 内六角带垫螺丝 M3*8 wash head hex screw	x5
3. 机臂A ArmA	x2	28. M2*25 圆形网纹铝柱 M2*25 Al. standoff	x3
4. 机臂B ArmB	x2	29. M2*8 内六角带垫螺丝 M2*8 wash head hex screw	x5
5. 底板 Bottom plate	x1	30. M2*8 内六角自攻螺丝 M2*8 self-tapping hex screw	x5
6. 脚垫打印件 Arm guard TPU	x1	31. M2*6 内六角沉头螺丝 M2*6 countersunk hex screw	x3
7. GPS座 GPS mount TPU	x1	32. 格纹硅胶电池防滑垫 Battery pad	x2
8. 可调节狗座底座打印件 GoPro bottom stand TPU	x1	33. 摄像头侧板CNC CNC camera side plate	x1
9. 前保险打印件 Front bumpers TPU	x1	34. 侧板 Side panels	x1
10. 后保险打印件 After bumpers TPU	x1	(附赠)/(Additional parts)	
11. 摄像头硅胶侧板 Silicone camera side plate	x1	1. M2*6 内六角螺丝 M2*6 hex screw	x2
12. 图传天线座打印件 Antenna TPU	x1	2. 集线管 Motor wire protector	x4
13. LED灯显LOGO 打印件 LED logo TPU	x1	3. 20*250超纤皮电池扎带 20*250 Battery strap	x2
14. BB响/蜂鸣器打印件 Buzzer holder TPU	x1	4. SMA天线棘轮打印件 SMA grip TPU	x2
15. GPS座侧板打印件 915 Antenna TPU	x1	5. M5螺母 M5 nut	x1
16. M3*22 圆形网纹铝柱 M3*22 Al. standoff	x5	6. 内六角扳手 Allen wrench	x1
17. M3 防松自紧螺母 M3 lock nut	x5	7. M5*20 内六角螺丝 M5*20 hex screw	x1
18. M3*8 内六角螺丝 M3*8 hex screw	x5	8. 通用贴纸V3 Sticker V3	x1
19. M3*10 内六角螺丝 M3*10 hex screw	x5	9. PEX直头转SMA直头内针转接线 总长6CM IPEX to RP-SMA F Adapter Cable 6CM	x2
20. M3*14 内六角螺丝 M3*14 hex screw	x5		
21. M3*30 内六角螺丝 M3*30 hex screw	x5		
22. M2*5 内六角螺丝 M2*5 hex screw	x5		
23. M3*9 内六角螺丝 M3*9 hex screw	x18		
24. M1.6*10 杯头内六角螺丝 M1.6*10 socket head cap	x5		
25. M3*29 圆形网纹铝柱 M3*29 Al. standoff	x3		

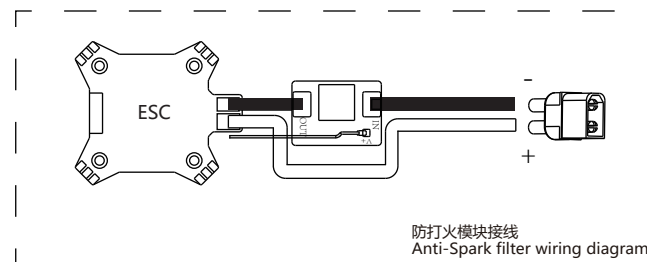
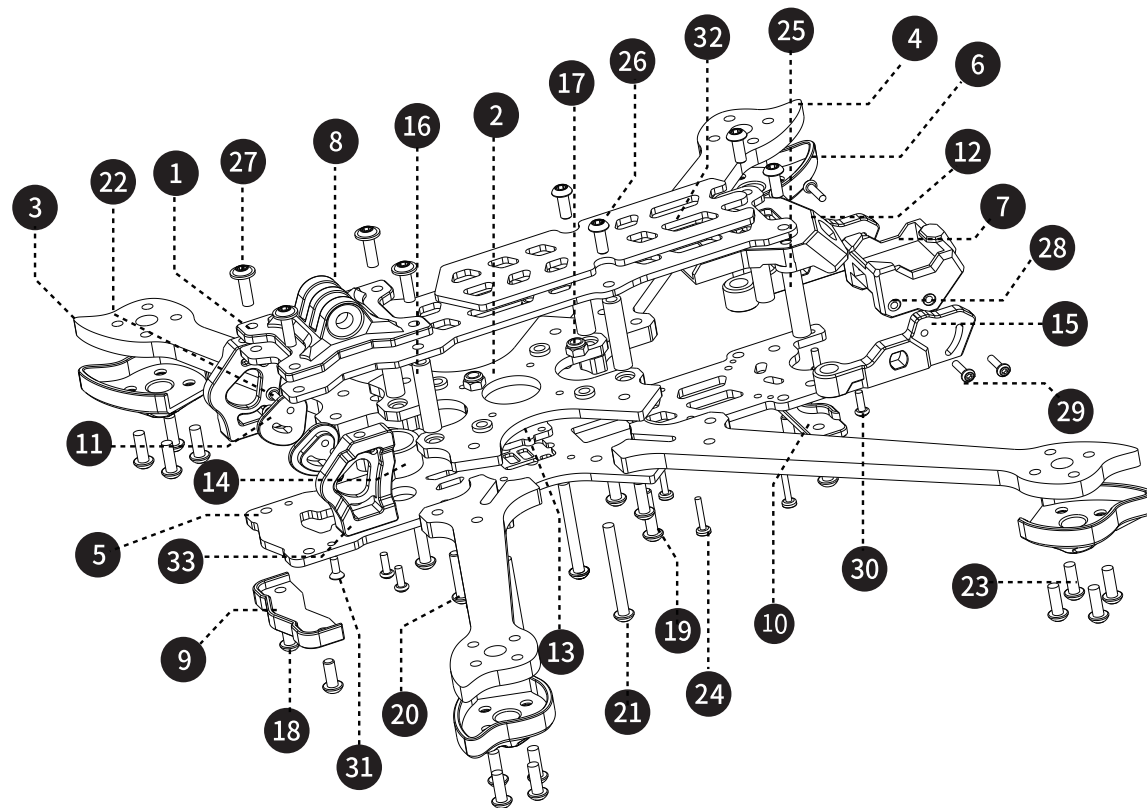

Nazgul ECO 侧板安装示意图

Nazgu ECO Side Panel Installation Diagram

