

# Nazgul DC5 ECO V1.1

## 机架组装示意图

## Frame Assembly Guide

|  |     |   |    |
|--|-----|---|----|
| 1. 顶板<br>Top plate                             | x1  | 26. M3*6 内六角螺丝<br>M3*6 hex screw                                | x5 |
| 2. 中板<br>Counter plate                         | x1  | 27. M3*8 内六角带垫螺丝<br>M3*8 wash head hex screw                    | x5 |
| 3. 机臂A<br>ArmA                                 | x2  | 28. M2*25 圆形网纹铝柱<br>M2*25 Al. standoff                          | x3 |
| 4. 机臂B<br>ArmB                                 | x2  | 29. M2*8 内六角带垫螺丝<br>M2*8 wash head hex screw                    | x5 |
| 5. 底板<br>Bottom plate                          | x1  | 30. M2*8 内六角自攻螺丝<br>M2*8 self-tapping hex screw                 | x5 |
| 6. 脚垫打印件<br>Arm guard TPU                      | x1  | 31. M2*6 内六角沉头螺丝<br>M2*6 countersunk hex screw                  | x3 |
| 7. GPS座<br>GPS mount TPU                       | x1  | 32. 格纹硅胶电池防滑垫<br>Battery pad                                    | x2 |
| 8. 可调节狗座底座打印件<br>GoPro bottom stand TPU        | x1  | 33. 摄像头侧板CNC<br>CNC camera side plate                           | x1 |
| 9. 前保险打印件<br>Front bumpers TPU                 | x1  | 34. 侧板<br>Side panels   | x1 |
| 10. 后保险打印件<br>After bumpers TPU                | x1  | (附赠)/(Additional parts)   |    |
| 11. 摄像头硅胶侧板<br>Silicone camera side plate      | x1  | 1. M2*6 内六角螺丝<br>M2*6 hex screw                                 | x2 |
| 12. 图传天线座打印件<br>Antenna TPU                    | x1  | 2. 集线管<br>Motor wire protector                                  | x4 |
| 13. LED灯显LOGO 打印件<br>LED logo TPU              | x1  | 3. 20*250超纤皮电池扎带<br>20*250 Battery strap                        | x2 |
| 14. BB响/蜂鸣器打印件<br>Buzzer holder TPU            | x1  | 4. SMA天线棘轮打印件<br>SMA grip TPU                                   | x2 |
| 15. GPS座侧板打印件<br>915 Antenna TPU               | x1  | 5. M5螺母<br>M5 nut   | x1 |
| 16. M3*22 圆形网纹铝柱<br>M3*22 Al. standoff         | x5  | 6. 内六角扳手<br>Allen wrench  | x1 |
| 17. M3 防松自紧螺母<br>M3 lock nut                   | x5  | 7. M5*20 内六角螺丝<br>M5*20 hex screw                               | x1 |
| 18. M3*8 内六角螺丝<br>M3*8 hex screw               | x5  | 8. 通用贴纸V3<br>Sticker V3   | x1 |
| 19. M3*10 内六角螺丝<br>M3*10 hex screw             | x5  | 9. PEX直头转SMA直头内针转接线 总长6CM<br>IPEX to RP-SMA F Adapter Cable 6CM | x2 |
| 20. M3*14 内六角螺丝<br>M3*14 hex screw             | x5  |   |    |
| 21. M3*30 内六角螺丝<br>M3*30 hex screw             | x5  |   |    |
| 22. M2*5 内六角螺丝<br>M2*5 hex screw               | x5  |   |    |
| 23. M3*9 内六角螺丝<br>M3*9 hex screw               | x18 |   |    |
| 24. M1.6*10 杯头内六角螺丝<br>M1.6*10 socket head cap | x5  |   |    |
| 25. M3*29 圆形网纹铝柱<br>M3*29 Al. standoff         | x3  |   |    |

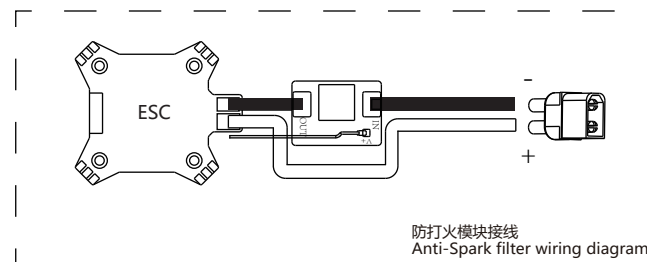
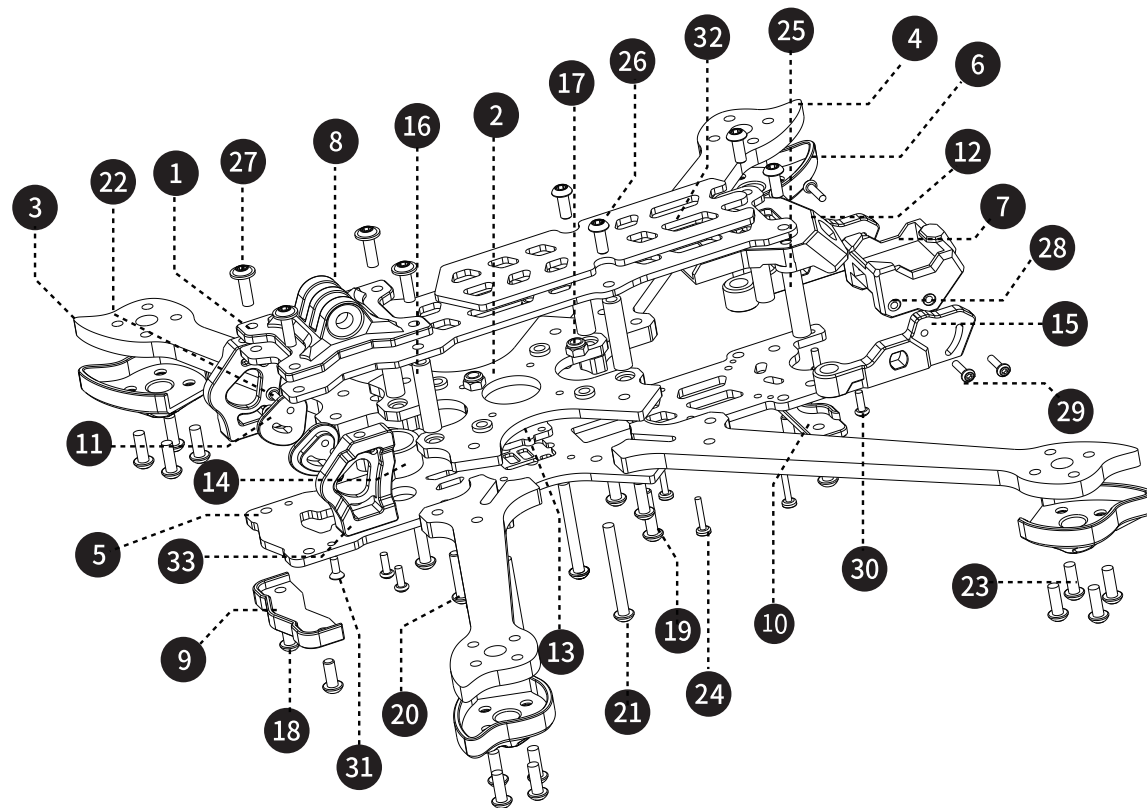

# Nazgul ECO 侧板安装示意图

## Nazgu ECO Side Panel Installation Diagram

